

WOK RANGE REPAIR PARTS

All of the parts listed are designed EXCLUSIVELY FOR TOWN FOOD SERVICE ASIAN EQUIPMENT. Our designs are continuously improved so older style parts may not be shown. However, most of the current items are adaptable to any of our equipment. Please contact our customer service department for assistance at (718) 388-5650. When calling it would expedite our assisting you if you have the following information: model number, serial number, gas type, date of purchase, dealer purchased from. Photos (email to customerservice@townfood.com) would also aid in identifying your needs. All parts purchases are non returnable and non refundable. We will replace any defective items, subject to our inspection of them. We do not recommend the use of our parts in NON Town equipment or for use in NON Asian cooking equipment. Purchase of such items for use in NON Town equipment is entirely at your own risk. NO WARRANTY OR GUARANTEE IS GRANTED BY SALE OF SUCH PARTS.

heavy
equipment



CHAMBER INSULATION PARTS
WHEN ORDERING REPLACEMENT BRICK PLEASE
INDICATE IF CHAMBER HAS A FLUE COLLAR.



FIBER CERAMIC CHAMBER INSULATION

YORK REPLACEMENT FIBER CERAMICS

ITEM NO.	FITS CHAMBER	INTERIOR DIAMETER	WEIGHT
225014N	13"	12"	6 lb.
225016N	16"	14"	7 lb.
225018N	18"	16"	8 lb.
225020N	20"	18"	9 lb.
225022N	22"	20"	12 lb.

MASTERRANGE REPLACEMENT FIRE BRICKS

ITEM NO.	DESCRIPTION	WEIGHT
225038	13" chamber brick set	55 lb.
225042	16" chamber brick set	65 lb.
225043	18" chamber brick set	75 lb.
225044	20" chamber brick set	85 lb.
225045	22" chamber brick set	95 lb.

RANGE CEMENT

For recementing refractory chamber insulation.

ITEM NO.	DESCRIPTION	WEIGHT
225009	20 lb. premixed cement	20 lb.



PREMIXED RANGE CEMENT
CAN BE USED DIRECTLY FROM CONTAINER

FLUE COLLAR COMPONENTS

ITEM NO.	DESCRIPTION	WEIGHT
225100	cast iron flue collar	15 lb.
FLUERISERCA	stainless steel flue cap	2 lb.
FLUERISER	standard flue riser	25 lb.
FLUERISERCUSTOM	custom flue riser ¹	

¹contact Town with dimensions for quote

GAS VALVES

ITEM NO.	DESCRIPTION
226102F	3/8" NPTF gas valve with short straight Town handle
226102F-2	3/8" NPTF gas valve with 'L' handle
226104M	1/2" NPTM gas valve, for older units with "L" handle
226103	Town handle only for 226102F gas valve
226105	'L' knee valve handle for 3/8" or 1/2" gas valve
226224	24" x 1/4" stainless steel compression pilot tubing
226201	1/4" compression x 1/8" NPT pilot valve
226824	1/4" compression coupling by 1/8" NPTM

PILOT BURNERS AND PARTS

ITEM NO.	DESCRIPTION
226202N	anti-clog pilot, natural gas
226203P	anti-clog pilot, propane gas
226202NT	anti-clog ring burner pilot, natural gas
226203PT	anti-clog ring burner pilot, propane gas
226824	1/8" NPT x 1/4" compression coupling
226204	anti-clog pilot orifice, natural gas
226205	anti-clog pilot orifice, propane gas
226203B	universal pilot bracket
226203BS	pilot bracket for safety

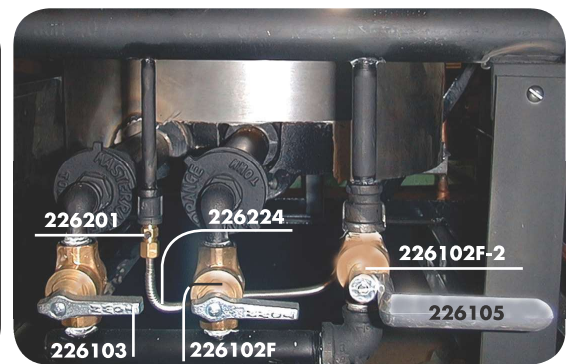
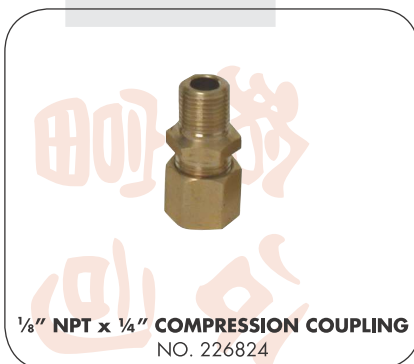

heavy
equipment

WOK RANGE REPAIR PARTS

CAST IRON CHAMBER RINGS

ITEM NO.	DESCRIPTION	WEIGHT
225113	13" chamber ring	39 lb.
225116	16" chamber ring	37 lb.
225118	18" chamber ring	43 lb.
225120	20" chamber ring	61 lb.
225122	22" chamber ring	64 lb.



**AVAILABLE AS REPLACEMENTS FOR RANGES
MANUFACTURED WITH CHAMBER RINGS ONLY
PLEASE SUPPLY MODEL AND SERIAL NUMBER WHEN ORDERING**

UNIVERSAL CAST IRON CHAMBER REDUCERS

Reduces chamber to 12" for use with Mandarin wok. Can fit other ranges if the outside chamber diameter is less than the reducer's interior diameter.

REDUCER SIZES

ITEM NO.	NOMINAL	OVERALL DIAMETER	INTERIOR DIAMETER	WEIGHT
229126	16" x 12"	17 $\frac{3}{8}$ "	16 $\frac{3}{4}$ "	28 lb.
229128	18" x 12"	19 $\frac{3}{4}$ "	19"	34 lb.
229122	20" x 12"	21 $\frac{3}{4}$ "	20 $\frac{7}{8}$ "	42 lb.
229124	22" x 12"	23 $\frac{3}{4}$ "	22 $\frac{7}{8}$ "	56 lb.



CHAMBER REDUCER KITS TOWN WOK RANGES ONLY

Reduces large chambers to a 13" opening for use with a 14"-16" wok. Converts bulk preparation chambers to a la carte service during peak periods. Made of epoxy coated steel except for 18" model which is cast iron.

ITEM NO.	DESCRIPTION	WEIGHT
229116N	16" to 13" chamber reducer kit	8 lb.
225113 ¹	18" to 13" chamber reducer kit	39 lb.
229120N	20" to 13" chamber reducer kit	10 lb.
229122N	22" to 13" chamber reducer kit	12 lb.

¹ 13" Mandarin chamber ring fits perfectly into an 18" Cantonese chamber ring.



REPLACEMENT DRIP PANS FOR RANGES¹

ITEM NO.	DESCRIPTION	WIDTH	WEIGHT
227113	small galvanized	13"	10 lb.
227116	medium galvanized	16 $\frac{1}{4}$ "	12 lb.
227120	large galvanized	19 $\frac{1}{4}$ "	15 lb.
227122	custom galvanized to customer's sketch		
227213	small stainless	13"	10 lb.
227216	medium stainless	16 $\frac{1}{4}$ "	12 lb.
227220	large stainless	19 $\frac{1}{4}$ "	15 lb.
227222	custom stainless to customer's sketch		

FOR UNITS WITH FRONT GUTTERS, CALL TOWN FOOD FOR INFORMATION

¹ all 29 $\frac{1}{4}$ " deep x 1" high

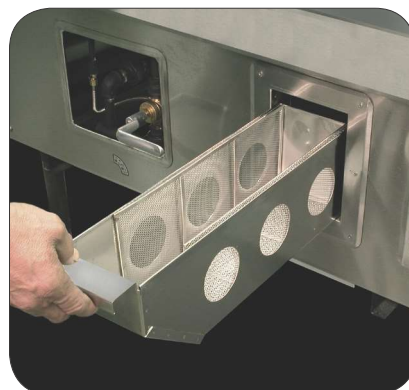

REPLACEMENT SINK BASKET INSERTS AND FRAMES

ITEM NO.	DESCRIPTION	SIZE: L x W x H	WEIGHT
229821	small frame	19" x 4 $\frac{3}{4}$ " x 6"	5 lb.
229822	small insert	14" x 4 $\frac{1}{2}$ " x 5 $\frac{3}{4}$ "	3 lb.
229934	large frame	21 $\frac{1}{2}$ " x 9" x 5 $\frac{7}{8}$ "	6 lb.
229935	large insert	16" x 8 $\frac{1}{2}$ " x 5 $\frac{3}{4}$ "	4 lb.

PLUMBING SUPPLIES

ITEM NO.	DESCRIPTION
226023	3 ring burner manifold
226021	left offset jet burner manifold
226022	right offset jet burner manifold
226526	¾" NPT street elbow
226528	¾" NPT union
226524-3/8	¾" NPT elbow
226613-3	¾" x 3" pilot gas nipple pilot gas nipple (⅛" center feed)
226614-4	¾" x 4" pilot gas nipple pilot gas nipple (⅛" center feed)
226615-CLPG	¾" x 5" pilot gas nipple pilot gas nipple (⅛" center feed)
226616-CLPG	¾" x 6" pilot gas nipple pilot gas nipple (⅛" center feed)

16 TIP VOLCANO BURNERS

ITEM NO.	DESCRIPTION	WEIGHT
226916N-W/PLT	16 tip volcano, natural	12 lb.
226916P-W/PLT	16 tip volcano, propane	12 lb.
226917	replacement tip for volcano burner, natural gas	
226918	replacement tip for volcano burner, propane gas	
226916C	replacement cover	4 lb.
226916N-CLNR	cleaning kit for 16 tip volcano burner, natural gas	
226916P-CLNR	cleaning kit for 16 tip volcano burner, propane gas	
226916B	cleaning brush	
226808-60	#60 tip cleaning drill, natural gas	
226808-73	#73 tip cleaning drill, propane gas	

VERTICAL SHIELD TIP BURNERS

ITEM NO.	DESCRIPTION	WEIGHT
226911N-W/PLT	18 tip vertical shield burner, natural	10 lb.
226911P-W/PLT	18 tip vertical shield burner, propane	10 lb.
226912	replacement tip for vertical shield tip burner, natural gas	
226914	replacement tip for vertical shield tip burner, propane gas	
226808-57	#57 tip cleaning drill, natural gas	
226808-72	#72 tip cleaning drill, propane gas	

ANGLE SHIELD TIP BURNERS

ITEM NO.	DESCRIPTION	WEIGHT
226920N-W/PLT	18 tip angle shield burner, natural	18 lb.
226920P-W/PLT	18 tip angle shield burner, propane	18 lb.
226921N	replacement tip for angle shield burner, natural gas	
226921P	replacement tip for angle shield burner, propane	
226808-58	#58 angle shield tip cleaning drill, natural gas	
226808-73	#73 angle shield tip cleaning drill, propane	



16 TIP VOLCANO BURNER
NO. 226916N/P



UNCOVERED VOLCANO BURNER



**VOLCANO BURNER
REPLACEMENT TIP**
NO. 226917 OR 226918



VERTICAL SHIELD TIP BURNER
NO. 226911N OR P



**SHIELD TIP BURNER
REPLACEMENT TIP**
NO. 226912/ NO. 226914



ANGLE SHIELD TIP BURNER
NO. 226920

heavy
equipment

23 AND 32 TIP JET BURNERS

ITEM NO.	DESCRIPTION
226800/N _____	23 tip Jet burner w/ pilot, natural gas
226800/P _____	23 tip Jet burner w/ pilot, propane gas
226804/N _____	32 tip Jet burner w/ pilot, natural gas
226804/P _____	32 tip Jet burner w/ pilot, propane gas
226806N _____	jet tip, natural, ⅛" NPT, s/n 58071 and above
226807P _____	jet tip, propane, ⅛" NPT, s/n 58071 and above
226806 _____	jet tip, natural, old type, metric thread
226807 _____	jet tip, propane, old type, metric thread
226810 _____	jet pilot, natural
226811 _____	jet pilot, propane
226822 _____	⅛" NPT x ¼" compression elbow
226808-60 _____	jet tip cleaning drill, natural
226808-72 _____	jet tip cleaning drill, propane
226800B _____	jet tip cleaning brush



23 TIP JET BURNER
NO. 226800N/P



32 TIP JET BURNER
NO. 226804N/P



OLD STYLE ⅛" NPT THREAD
NO. 226806/226807



NEW STYLE METRIC THREAD
NO. 226806N/226807P



JET PILOT
NO. 226810/226811



COMPRESSION ELBOW
NO. 226822

BURNER REPAIR TOOLS

ITEM NO.	DESCRIPTION
226808H _____	handle for tip cleaning drill
226940 _____	wrench for shield tip burner

CLEANING KITS

ITEM NO.	DESCRIPTION
226916-N/P CLNR _____	volcano burner cleaning kit
226800-N/P CLNR _____	jet tip cleaning kit



**VOLCANO BURNER
CLEANING KIT**
NO. 226916 N/P CLNR



JET TIP CLEANING KIT
NO. 226800-N/P CLNR



**SHIELD TIP BURNER
WRENCH**
NO. 226940



**HANDLE FOR
TIP CLEANING DRILL**
NO. 226808H

AIR MIXER ASSEMBLY

3/8" AIR MIXER STREET ELBOW
NO. 226526



AIR MIXER ORIFICE
NO. 226117 (NATURAL)
NO. 226119 (PROPANE)



3/8" AIR MIXER NIPPLE
NO. 226609



AIR MIXER SET SCREW NO. 226115



2 RING BURNER NO. 226130

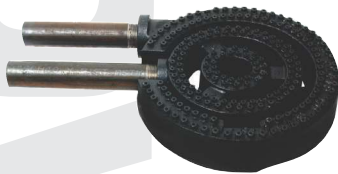

3 RING BURNER NO. 226131

1/2" NPT OR 3/8" NPT



**1/2" NPT SAFETY,
PILOT OUT ONLY,
TS11K/COMPLETE**
NO. 249002

36" THERMOCOUPLE
NO. 252238



**UNIVERSAL PILOT
BRACKET, S/N
58071 AND ABOVE**
NO. 22603B



12 TIP NO CLOG BURNER
NO. 226960N/P

AIR MIXER PARTS FOR 2 AND 3 RING BURNERS

ITEM NO.	DESCRIPTION
226110	air mixer assembly, natural
226111	air mixer assembly, propane
226117	air mixer orifice, natural
226119	air mixer orifice, propane
226115	air mixer set screw
226609	3/8" air mixer nipple
226526	3/8" air mixer street elbow

RING BURNERS

SPECIFY NIPPLE LENGTH WHEN ORDERING

ITEM NO.	DESCRIPTION	WEIGHT
226130-W/PLT	2 ring burner/nipple for range	14 lb.
226131-W/PLT	3 ring burner/nipples for range	30 lb.
226130-18	2 ring burner/nipples for SR-18	14 lb.
226131-24	3 ring burner/nipples for SR-24	30 lb.

SAFETY PILOT PARTS FOR RANGES

ITEM NO.	DESCRIPTION
249002	1/2" NPT safety, pilot out only, TS11K/complete
249011	3/8" NPT safety pilot out only TS11K/complete
249011-H	safety head repair kit
252238	36" HD thermocouple/MBR/WOKS/custom
249006	36" thermocouple for SM units only
252239	safety pilot for jet burners
252241	safety pilot for ring burners
226203B	universal pilot bracket, s/n 58071 and above
226203BS	bracket for safety pilots

9 AND 12 TIP ANTI-CLOG BURNERS

1/2" NPT INLET

Available only as replacements for ranges manufactured with No-Clog burners. Please provide range serial number when ordering.

ITEM NO.	DESCRIPTION	WEIGHT
226950N-W/PLT	9 tip no-clog, natural	25 lb.
226950P-W/PLT	9 tip no-clog, propane	25 lb.
226960N-W/PLT	12 tip no-clog, natural	25 lb.
226960P-W/PLT	12 tip no-clog, propane	25 lb.
226952	replacement tip, natural	
226953	replacement tip, propane	
226950/60C	no-clog replacement cover for 9 and 12 tip burner	10 lb.
226808-56	tip cleaning drill, natural, #56	
226808-70	tip cleaning drill, propane, 9 tip, #70	
226808-71	tip cleaning drill, propane, 12 tip, #71	

heavy
equipment

WOK RANGE REPAIR PARTS

Auto-Flo™ –The original swing faucet beware of imitations!

One piece cast brass body and heat proof internal parts let our faucet outlast all others.

Look for the **Auto-Flo™** stamped on the body.

heavy
equipment

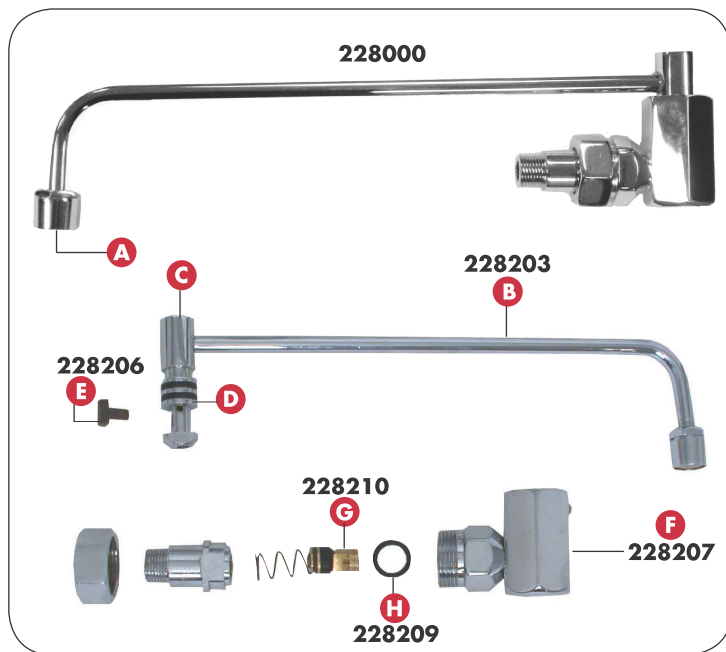

COMPLETE SWING FAUCET

ITEM NO.	DESCRIPTION	WEIGHT
228000	3/8" swing faucet, complete	3 lb.

SWING FAUCET PARTS

ITEM NO.	DESCRIPTION
228102	A aerator
228203	B spout
228204	C spindle
228205	D "O" rings (union washer)
228206	E water switch
228207	F screw
228209	G spring washer
228210	H replacement washer
228200	repair kit, contents
	• (1) water switch
	• (1) spring washer
	• (3) "O" rings (union washers)

PEDESTAL FAUCETS

- Faucet pedestal for low profile ranges
- Auto-Flo™, manual or double jointed faucets can be used

ITEM NO.	DESCRIPTION	HEIGHT
228000PSF	pedestal w/swing faucet	9"
228000PSFT	extended pedestal swing faucet	13"
229008	pedestal w/cube faucet connection	9"
229008-15	pedestal w/cube faucet connection	13"

Note: pedestals can be fitted with manual faucets.
Please order separately.

MANUAL FAUCETS

8 1/2" SHANK, HOSPITAL HANDLE
SEE IMAGE, PAGE 61

- Positioned over stockpots or between chambers
- Useful when steady water flow is preferred

ITEM NO.	SPOUT LENGTH	OVERALL LENGTH
229003-6	6"	14 1/4"
229003-8	8"	16 1/4"
229003-10	10"	18 1/4"
229003-12	12"	20 1/4"
229003-14	14"	22 1/4"
229003-16	16"	24 1/4"

WARMER AND BIB FAUCETS

SEE IMAGE, PAGE 61

- For soup warming chambers
- Not for oil chambers

ITEM NO.	SPOUT LENGTH	OVERALL LENGTH
229004B	n/a	5"
229004-6	6"	8 5/8"



TOP MOUNTED PEDISTAL FAUCET



MANUAL FAUCET 8 1/2" SHANK, WRIST HANDLE

REMOTE VALVE FAUCETS

- Recommended when faucets are close to chamber
- Remote valve is generally mounted on front panel

DESCRIPTION	SPOUT LENGTH	DESCRIPTION
229009-1	6"	fixed spout
229009-2	12"	swivel spout

GAS AND WATER PRESSURE REGULATORS

ITEM NO.	DESCRIPTION
226895	1 1/4" pressure regulator, natural FOR WOKS, MBR'S AND STEAMERS
226896	1 1/4" pressure regulator, propane FOR WOKS, MBR'S AND STEAMERS
RM-55-N-REG	RV48 3/4" NPT (natural) FOR RM-50-55 RICE COOKERS, STOCKPOT STOVES
RM-55-P-REG	RV48 3/4" NPT (propane) FOR RM-50-55 RICE COOKERS, STOCKPOT STOVES
249047	RV47 3/8" NPT universal regulator FOR SMOKEHOUSES
226308	3/8" NPT water pressure flow regulator ¹

¹ also used on steamers, wok ranges, and custom units

MANUAL FAUCETS

2 5/8" SHANKWRIST HANDLE ASSEMBLY

- Faucet body closer to backsplash
- For chefs preferring obstruction free work area

ITEM NO.	SPOUT LENGTH	OVERALL LENGTH
229004/6	6"	8 5/8"
229004/8	8"	10 5/8"
229004/10	10"	12 5/8"
229004/12	12"	14 5/8"
229004/14	14"	16 5/8"
229004/16	16"	18 5/8"

MANUAL FAUCET PARTS

ITEM NO.	DESCRIPTION
229004	2 5/8" shank swivel base faucet
229004H	wrist blade handle
229007/6	6" spout
229007/8	8" spout
229007/10	10" spout
229007/12	12" spout
229007/14	14" spout
229007/16	16" spout

DOUBLE JOINTED FAUCETS

2 5/8" SHANK, HOSPITAL HANDLE

- Ideal for extra long reach applications

ITEM NO.	LAST SPOUT LENGTH	OVERALL LENGTH
229007-6	6"	20 5/8"
229007-10	10"	26 5/8"



BIB FAUCET

heavy
equipment

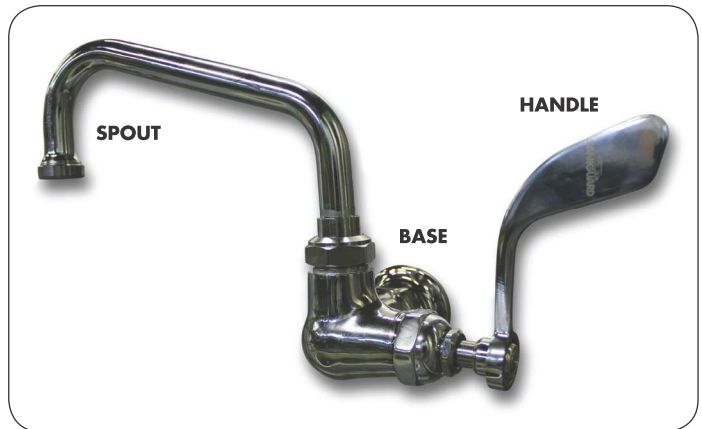

MANUAL FAUCET WITH WRIST HANDLE



DOUBLE JOINTED FAUCET